

PRODUCT DATA SHEET

SKP STANDARD TYPE CABLE LUG



DESCRIPTION

A cable lug is attached to an electrical device such as a wire or cable and then securely fastened to its end using a crimp tool and crimp die.

FEATURES

- Made of copper material in accordance with EN/13600 standards.
- Annealed copper pipes are used during production.
- Copper with 99.9% conductivity is used in production.
- 100% Tin coating is made in the range of 5-8 Microns.

MARKINGS



- It complies with CE standards.
- It complies with RoHS standards.
- It complies with ISO 9001 standards.
- It complies with IEC standards.
- It complies with TSE standards.
- Domestic Production.

PRODUCT DATA SHEET

SKP STANDARD TYPE CABLE LUG

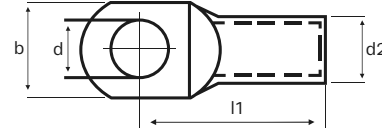
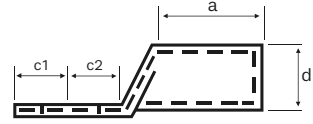

SECTIONS AND DIMENSIONS

PRODUCT CODE	CABLE SECTION (mm ²)	BORE DIAMETER Ø	DIMENSIONS							
			d	d1	d2	l1	a	b	c1	c2
SKP-S 10-5	10 mm ²	M5	5,5	4,7	6,6	22,0	10,0	10,3	5,5	7,0
SKP-S 10-6		M6	6,5	4,7	6,6	22,0	10,0	10,3	5,5	7,0
SKP-S 10-8		M8	8,5	4,7	6,6	23,7	10,0	13,5	6,8	8,7
SKP-S 16-5	16 mm ²	M5	5,5	5,6	7,8	24,0	12,0	11,2	5,5	6,5
SKP-S 16-6		M6	6,5	5,6	7,8	24,0	12,0	11,2	5,5	6,5
SKP-S 16-8		M8	8,5	5,6	7,8	26,2	12,0	13,5	6,8	8,7
SKP-S 16-10		M10	10,5	5,6	7,8	26,0	12,0	16,0	7,5	8,5
SKP-S 25-6	25 mm ²	M6	6,5	7,1	9,5	32,2	16,0	13,7	6,8	9,2
SKP-S 25-8		M8	8,5	7,1	9,5	32,2	16,0	13,7	6,8	9,2
SKP-S 25-10		M10	10,5	7,1	9,5	34,0	16,0	16,0	8,0	11,0
SKP-S 35-6	35 mm ²	M6	6,5	8,2	10,8	35,7	19,0	15,3	8,3	9,7
SKP-S 35-8		M8	8,5	8,2	10,8	35,7	19,0	15,3	8,3	9,7
SKP-S 35-10		M10	10,5	8,2	10,8	38,0	19,0	15,7	10,0	12,0
SKP-S 35-12		M12	13,0	8,2	10,8	38,0	19,0	18,0	10,0	12,0
SKP-S 50-6	50 mm ²	M6	6,5	10,1	13,0	39,2	21,0	18,9	8,3	9,7
SKP-S 50-8		M8	8,5	10,1	13,0	39,2	21,0	18,9	8,3	9,7
SKP-S 50-10		M10	10,5	10,1	13,0	41,5	21,0	18,9	10,0	12,0
SKP-S 50-12		M12	13,0	10,1	13,0	41,5	21,0	18,9	10,0	12,0
SKP-S 70-8	70 mm ²	M8	8,5	11,5	14,7	42,3	23,0	21,1	8,3	9,7
SKP-S 70-10		M10	10,5	11,5	14,7	44,6	23,0	21,1	10,0	12,0
SKP-S 70-12		M12	13,0	11,5	14,7	44,6	23,0	21,1	10,0	12,0
SKP-S 70-14		M14	15,0	11,5	14,7	47,6	23,0	21,5	15,0	15,0
SKP-S 70-16		M16	17,0	11,5	14,7	47,6	23,0	21,5	15,0	15,0